



The Mill and Drill

Vol 1, Issue 29 (Feb. 11,
2005)

DEAR CUSTOMER

Welcome to your weekly installment of "*The Mill & Drill*", TriMech Mfg.'s Technical Newsletter for FeatureCAM. This newsletter is intended to keep you, the hip TriMech FeatureCAM User, on the cutting edge of your FeatureCAM seat. Don't forget to visit www.trimech.com for additional information.

NOTICES

FeatureCAM is adding Machine Simulation.

Even as you enjoy the power and ease-of-use of FeatureCAM 2005, EGS is working hard on the next version of FeatureCAM. **Machine Simulation** is an exciting enhancement that is on the way. You will actually be able to see your *entire machine* during simulation, and the simulation will detect collisions. We will provide more details as they come available, but in the meantime you can read the press release at www.featurecam.com

Did you miss a newsletter?

Don't worry, the newsletters are posted, every issue, in PDF format on the TriMech Web Site (www.trimech.com). Just hover over TriMech Manufacturing, Technical Support and you will see *The Mill & Drill* letters to the right side.

Is there anybody else at your company who would like to receive the newsletter?

Send us their name and e-mail address, and we'll add them to the list.

FeatureCAM TRAINING SCHEDULE

Note: Our main training facility is in Fishersville, VA, but we can make special arrangements for classes at any of our other TriMech offices (Columbia, MD; Pittsburgh, PA; Richmond, VA; Durham, NC; and Charlotte, NC). We also provide on-site training. Call (540) 949-7703 for rates and details.

Fishersville, VA	
FeatureCAM Basic (2 days)	Feb. 9,10 Mar. 9,10
FeatureCAM Advanced Milling	Feb. 17 Mar. 17
FeatureCAM Turning	TBD
TIPS AND TRICKS	

Tap Drill Sizes

FeatureCAM automatically selects tap drills based on the thread percentage for cutting taps and rolled taps. These percentages can be edited, and are found on the **Tool Selection** tab of your **Machining Attributes/Configurations**.

Thread % for tap drill (cut)	<input type="text" value="77"/>	%
Thread % for tap drill (rolled)	<input type="text" value="65"/>	%

If you want even more control over which drills are selected for taps, you can specify specific drill sizes for specific taps. Here's how: Access the properties for a tap through the Tool Manager. Clear the Calculated checkbox beside the Drill Diameter field and enter the desired tool size.

Drill Diameter	<input type="text" value="0.08699"/>	in.	<input type="checkbox"/> Calculated
----------------	--------------------------------------	-----	-------------------------------------

Exit the Tool Manager, saving all changes. From now on, FeatureCAM will use the designated drill size whenever it uses that tap.

Tool Colors

Normal 3D simulation shows yellow tools, and the material is a silver color where it has been cut. Turning on Tool Colors will show the tools and where they cut in different colors. Tool Colors can be found under **Manufacturing > Simulation > General**.

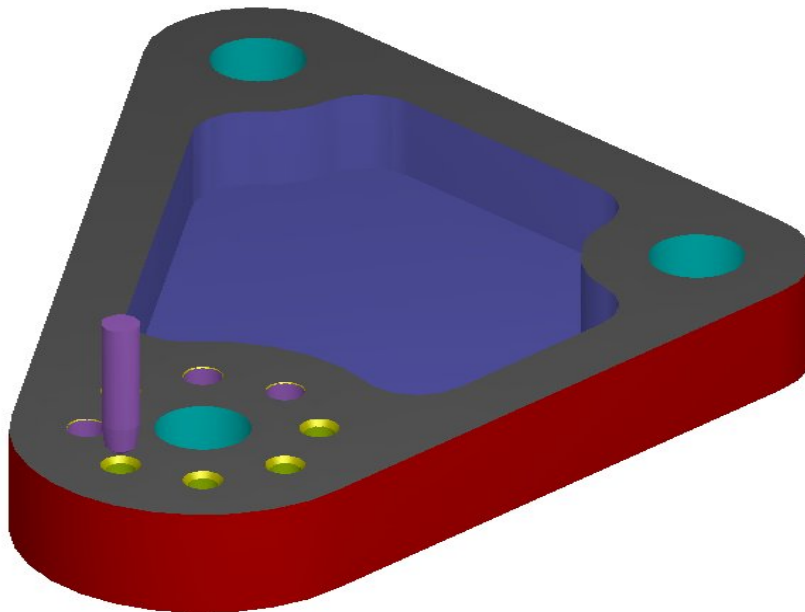

Resizing the Results/Toolbox

Do you ever wish you could see more of the information in the Results window? Sure, you can scroll left and right, but that's a pain. To resize the window, open it and place your cursor on the edge. It will change from the typical arrow to two vertical lines with small arrows pointing left and right. Now left-click on the edge of the window, hold down your mouse button, and drag it out. You can resize the Toolbox window the same way.

QUESTIONS/COMMENTS?

Please send any tips/tricks, feedback (regarding this newsletter)
or requests to be added/removed from our distribution list to...

jkanney@trimech.com